

LEFT JUSTIFY ROAD NAME ON BLADE HORIZONTALLY AND CENTER VERTICALLY. 9" HIGH INTENSITY GRADE REFLECTIVE SHEETING, 6" UPPER CASE AND 4.5" LOWER CASE GOTHIC SERIES "C" WHITE HIGH INTENSITY REFLECTIVE LETTERS.

3" UPPER CASE SERIES "C" HIGH INTENSITY LETTERS, MARGIN TO TOP.

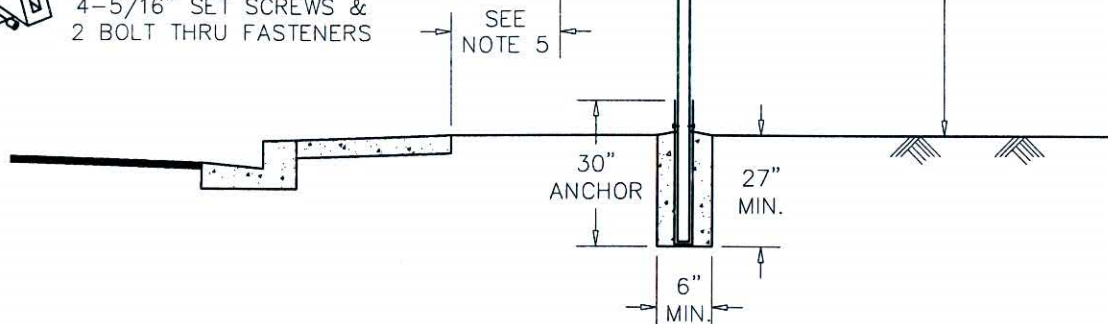
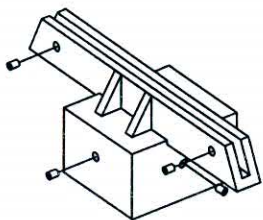
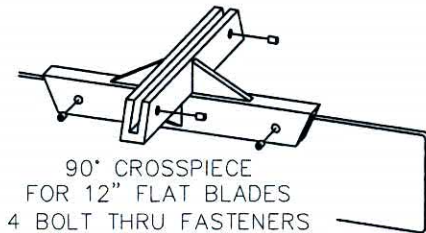

**NOTES:**

1. STOP SIGN SHALL BE CALTRANS TYPE R1-1 (30") OR (36") HIGH INTENSITY PRISMATIC GRADE REFLECTIVE SHEETING.
2. STREET NAME SIGN BLANK SHALL BE 0.125" THICK, HIGH INTENSITY GRADE REFLECTIVE SHEETING. COLOR OF SHEETING SHALL BE GREEN FOR COUNTY ROAD APPLICATION AND BLUE FOR PRIVATE ROAD APPLICATION. THERE SHALL BE A 1/2" WHITE BORDER AROUND SIGN.
3. POSTS SHALL BE 2" X 2" SQUARE 14-GAUGE UNISTRUT STEEL TUBING SET IN 30" X 2.5" X 2.5" 7-GAUGE ANCHOR. ANCHOR SHALL BE SET IN CONCRETE 6" DIA. X 27" (MIN).
4. STOP SIGN MAY BE INSTALLED BELOW STREET SIGN WITH A MINIMUM OF 7' OF VERTICAL CLEARANCE FROM FINISHED GRADE OF SIDEWALK OR FROM EDGE OF NEAREST PAVEMENT. IN RURAL AREAS WITH NO PEDESTRIAN TRAFFIC THE MINIMUM VERTICAL CLEARANCE SHALL BE 5' FROM EDGE OF NEAREST PAVEMENT.
5. MINIMUM HORIZONTAL CLEARANCE SHALL BE 2' FROM BACK OF CURB, 6" FROM BACK OF SIDEWALK, OR 6' FROM IMPROVED SHOULDERS. NO SIGNS SHALL EXTEND OVER THE BACK OF CURB.
6. STREET NAME SIGN, NOT COMBINED WITH STOP SIGN, MAY BE LOCATED AT CENTER OF CURB RETURN. STOP SIGN SHALL BE LOCATED AT BEGINNING OF CURB RETURN.
7. EXACT LOCATIONS OF ALL SIGNS SHALL BE SHOWN ON STREET IMPROVEMENT PLANS.

YUBA COUNTY DEPARTMENT OF PUBLIC WORKS	
STREET SIGNS	
 APPROVED BY:	1/11/10 DATE:
503	